



SPECIAL MESH BAR GRATING

special mesh

SPECIAL CLOSE MESH

Deflections as per table on page 13.

Type 11

ADA Compatible with 3/16" bars 
Multiply load values by 1.72 as per table on page 13.

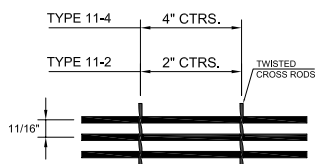

Type 15

Multiply load values by 1.25 as per table on page 13.

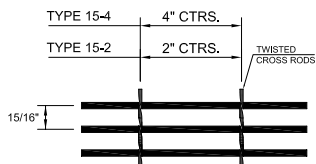

SPECIAL WIDE MESH

Deflections as per table on page 13.

Type 26

Multiply load values by 0.73 as per table on page 13.

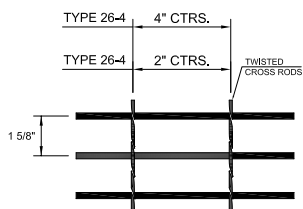

Type 30

Multiply load values by 0.63 as per table on page 13.

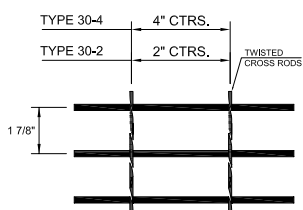

Type 38

Multiply load values by 0.50 as per table on page 13.

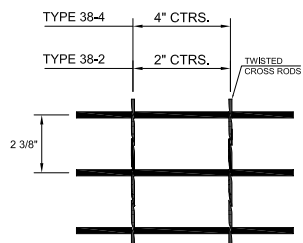

IMPERIAL PANEL WIDTH IN INCHES (For 3/16" bearing bars)						
# OF BARS	CLOSE MESH		STANDARD MESH	WIDE MESH		
	TYPE 11	TYPE 15	TYPE 19	TYPE 26	TYPE 30	TYPE 38
2	7/8	1 1/8	1 3/8	1 27/32	2 1/16	2 9/16
3	1 9/16	2 1/16	2 9/16	3 15/32	3 15/16	4 15/16
4	2 1/4	3	3 3/4	5 3/32	5 13/16	7 5/16
5	2 15/16	3 15/16	4 15/16	6 23/32	7 11/16	9 11/16
6	3 5/8	4 7/8	6 1/8	8 11/32	9 9/16	12 1/16
7	4 5/16	5 13/16	7 5/16	9 31/32	11 7/16	14 7/16
8	5	6 3/4	8 1/2	11 19/32	13 5/16	16 13/16
9	5 11/16	7 11/16	9 11/16	13 7/32	15 3/16	19 3/16
10	6 3/8	8 5/8	10 7/8	14 27/32	17 1/16	21 9/16
11	7 1/16	9 9/16	12 1/16	16 15/32	18 15/16	23 15/16
12	7 3/4	10 1/2	13 1/4	18 3/32	20 13/16	26 5/16
13	8 7/16	11 7/16	14 7/16	19 23/32	22 11/16	28 11/16
14	9 1/8	12 3/8	15 5/8	21 11/32	24 9/16	31 1/16
15	9 13/16	13 5/16	16 13/16	22 31/32	26 7/8	33 7/16
16	10 1/2	14 1/4	18	24 19/32	28 5/16	35 13/16
17	11 3/16	15 3/16	19 3/16	26 7/32	30 3/16	
18	11 7/8	16 1/8	20 3/8	27 27/32	32 1/16	
19	12 9/16	17 1/16	21 9/16	29 15/32	33 15/16	
20	13 1/4	18	22 3/4	31 3/32	35 13/16	
21	13 15/16	18 15/16	23 15/16	32 23/32		
22	14 5/8	19 7/8	25 1/8	34 11/32		
23	15 5/16	20 13/16	26 5/16	35 31/32		
24	16	21 3/4	27 1/2			
25	16 11/16	22 11/16	28 11/16			
26	17 3/8	23 5/8	29 7/8			
27	18 1/16	24 9/16	31 1/16			
28	18 3/4	25 1/2	32 1/4			
29	19 7/16	26 7/16	33 7/16			
30	20 1/8	27 3/8	34 5/8			
31	20 13/16	28 5/16	35 13/16			
32	21 1/2	29 1/4				
33	22 3/16	30 3/16				
34	22 7/8	31 1/8				
35	23 9/16	32 1/16				
36	24 1/4	33				
37		33 15/16				
38		34 7/8				
39		35 13/16				
40						
41						

Dimensions shown are out to out of bearing bars.
For 1/8" bearing bars, deduct 1/16" from panel width.

*All weights will increase by 5% when galvanized.